

LAY-OUT ST-ROL CONTROL UNIT

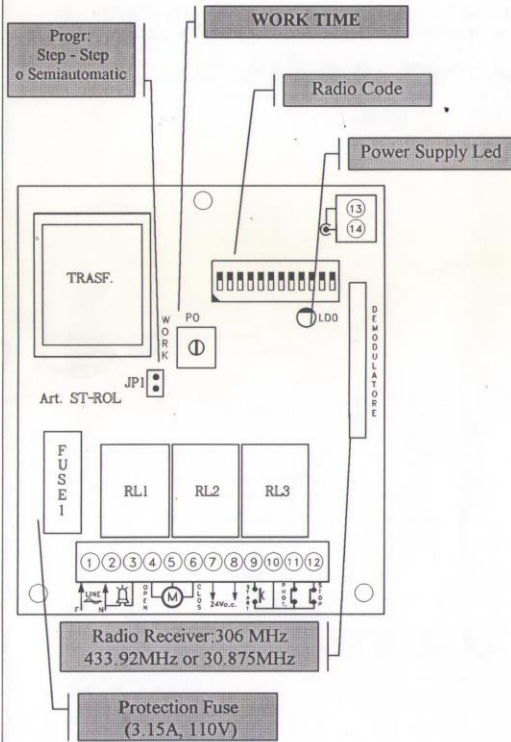

ELECTRICAL CONNECTIONS

N° MORS	CONNECTION
1-2	LINE 110Vac/ 50/60Hz
2-3	COURTESY LIGHT 110Vac/ 50/60Hz
4	OPEN - MOTOR
5	COMMON - MOTOR
6	CLOSE - MOTOR
7-8	AUX OUTPUT 24Vac/100ma MAX
9-10	N.O. CONTACT - CONNECTION TO START BUTTON O KEY SELECTOR
11-10	N.C. CONTACT -CONNECTION TO SAFETY PHOTOCELL
12-10	N.C. CONTACT - CONNECTION TO STOP BUTTON
13	CONNECTION TO ANTENNA SHIELD
14	CONNECTION TO ANTENNA

Tab.1

N.B: SHORT CIRCUIT STOP AND PHOTOCELL CONTACTS IF NOT USED

PROGRAMS

PROGRAM	JP 1
Program 1 (Step -Step)	OFF
Program 2 (Semiautomatic)	ON

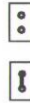

Control Unit ST97- v1.0

FUNCTIONS

Jumper JP1

- | | |
|-------------|---|
| OFF: | First START impulse opens, second START stop, third START closes, next START stop. |
| ON: | First START impulse opens, second START stop, third START closes, next START reverts after a break of 2sec. |

WARNING:

- c e 95 directives:89386/CEE (Electromagnetic compatibility) 9368/CEE (Low Tension)

CONTROL UNIT FOR ROLLING SHUTTERS ST-ROL

Operation characteristics:

- ◆ Programming by setting Jumper 1
- ◆ Work time adjust from 2sec up to 40sec by using trimmer WORK
- ◆ Safety photocell Input
- ◆ 24Vac AUX Output for Safety photocell power supply
- ◆ 2 min. Courtesy light 110Vac
- ◆ Protection fuse 3.15A

Technical Characteristic

POWER SUPPLY:	110-125Vac 50-60Hz
EL. MOTOR OUTPUT:	400VA 110Vac
FUSE F1:	3.15A
COURT. LIGHT OUTPUT:	110Vac
AUX:	24Vac 100mA max
MOTOR RELAY:	10A
INVERSION TIME:	2 sec
RADIO:	Radio receiver on board: 306.5, 433.92, 30.875 MHz.

STANTEC S.p.A.
+39-0521-451101

forma
no- informazioni.it

Control Unit ST97-V 1.0